

MR16 white light 4200K & 3400K

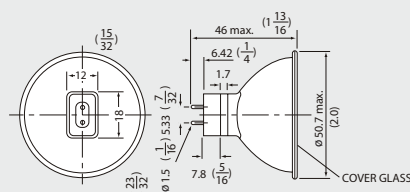

PHYSICAL DATA AND CHARACTERISTICS

Type	Ref. ANSI	Volts (V)	Watts (W)	Base	Colour Temp. (K)	Std. Pkg. Qty.	Axis Cd (cd)	Beam Angle (°)	Rated Av. Life (hrs)
MR16 4200K with cover glass									
JR1256	BAB	12	20	GU5.3	4200	12	220	38	4000
JR1356	FMW	12	35	GU5.3	4200	12	500	38	5000
JR1580	EXN	12	50	GU5.3	4200	12	840	38	5000
JR1581	FNV	12	50	GU5.3	4200	12	300	56	5000
MR16 3350K, 3450K with cover glass									
JR1251D	ESX	12	20	GU5.3	3350	12	2200	10	4000
JR1253D	BAB	12	20	GU5.3	3350	12	400	36	4000
JR1351D	FRB	12	35	GU5.3	3450	12	4200	12	5000
JR1353D	FMW	12	35	GU5.3	3450	12	880	36	5000
JR1551D	EXT	12	50	GU5.3	3450	12	5300	12	5000
JR1552D	EXZ	12	50	GU5.3	3450	12	2250	26	5000
JR1554D	EXN	12	50	GU5.3	3450	12	1300	36	5000
MR16 3450K 10,000 hrs long life with cover glass									
JR8371	FRB	12	35	GU5.3	3450	12	4200	12	10000
JR8372	FRA	12	35	GU5.3	3450	12	1400	23	10000
JR8373	FMW	12	35	GU5.3	3450	12	880	36	10000
JR8571	EXT	12	50	GU5.3	3450	12	5300	12	10000
JR8572	EXZ	12	50	GU5.3	3450	12	2250	25	10000
JR8574	EXN	12	50	GU5.3	3450	12	1300	36	10000

MR16 low voltage halogen lamp with cover glass with higher colour temperature.

FEATURES

- White light – colour temperature 4200K and 3350 to 3450K
- Precise optical design.
- Long lasting dichroic coating.
- Reliable long life.
- Suitable for Jewellery, display cases, retail stores, museums, landscape lighting, beauty salons.