

MR16 with cover glass

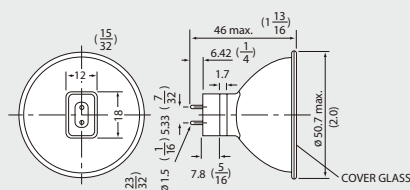

PHYSICAL DATA AND CHARACTERISTICS

Type	Ref. ANSI	Volts (V)	Watts (W)	Base	Std. Pkg. Qty.	Axis Cd (cd)	Colour Temp. (K)	Beam Angle (°)	Rated Av. Life (hrs)
JR1251	ESX	12	20	GU5.3	12	4000	2950	9	4000
JR1252	BBF	12	20	GU5.3	12	880	2950	23	4000
JR1253	BAB	12	20	GU5.3	12	500	2950	38	4000
JR1351	FRB	12	35	GU5.3	12	7600	3050	12	5000
JR1352	FRA	12	35	GU5.3	12	2300	3050	23	5000
JR1353	FMW	12	35	GU5.3	12	1100	3050	38	5000
JR1451	EYR	12	42	GU5.3	12	7500	3050	12	5000
JR1452	EYS	12	42	GU5.3	12	2600	3050	25	5000
JR1453	EYP	12	42	GU5.3	12	1100	3050	38	5000
JR1551	EXT	12	50	GU5.3	12	9800	3050	13	5000
JR1552	EXZ	12	50	GU5.3	12	3200	3050	26	5000
JR1553	ENL	12	50	GU5.3	12	2250	3050	32	5000
JR1554	EXN	12	50	GU5.3	12	1600	3050	38	5000
JR1566	FNV	12	50	GU5.3	12	700	3050	55	5000
JR2651	FPA	12	65	GU5.3	12	12000	3050	13	5000
JR2652	FPC	12	65	GU5.3	12	4100	3050	26	5000
JR2653	FPB	12	65	GU5.3	12	2100	3050	38	5000
JR2751	EYF	12	75	GU5.3	12	12700	3050	13	5000
JR2752	EYJ	12	75	GU5.3	12	4400	3050	26	5000
JR2753	EYC	12	75	GU5.3	12	2200	3050	44	5000

* DC bayonet base is also available.

MR16 low voltage halogen lamp with cover glass.

FEATURES

- Precise optical design.
- Long lasting dichroic coating.
- Reliable long life.
- Suitable for retail stores, lounges, offices, landscape lighting, display cases, homes.