

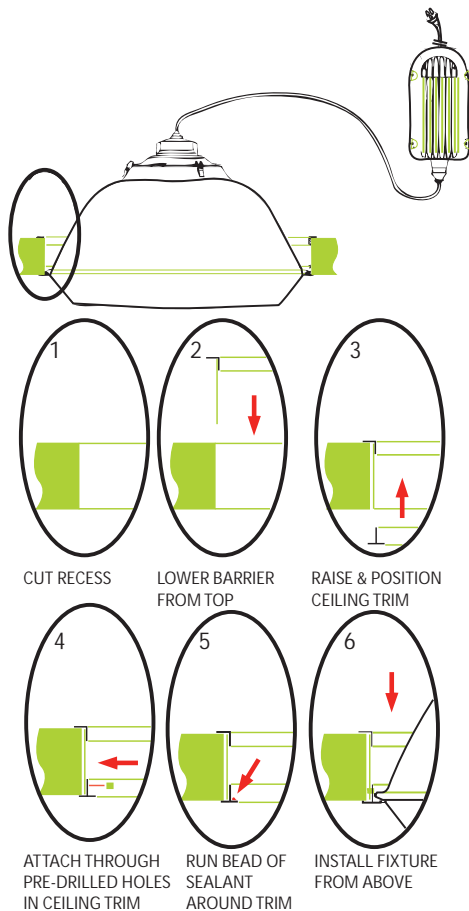

PRISMCAST RECESSED FLANGE KIT

Recessed Flange Kit



Installation Instructions

1. Location

The Semi-Recessed version is designed to mount into 100mm sandwichboard. This Rodent Barrier version is designed for 75mm & 100mm sandwichboard only. As nominated by installer.

2. Mounting Detail

Rodent Barrier Version: Holes mounting T angle to barrier will be done by installer. See diagram.

IMPORTANT Ensure to read installation instructions carefully taking close attention to Point 1.

3. General Care and Maintenance

Clean excessive build-up of foreign material to outer surfaces of the reflector and control gear to maintain the performance of the product.

PLEASE NOTE For freezer and cold room applications, seek technical advice from freezer room manufacturers on installation of this product and from Spectra Lightings Technical Department.

Important Safety Instructions

Before carrying out any servicing, ensure that the mains supply is fully isolated. Voltages greater than mains voltage can be present during operation.

Please read all instructions carefully.
Failure to follow these instructions may void warranty.
This equipment is to be installed by qualified electricians only.